

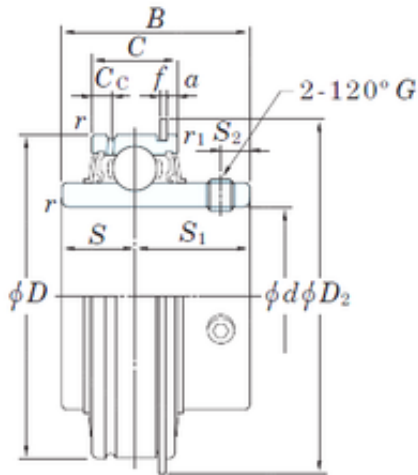

ASAHI FORGE OF AMERICA BEARING CORP.



25 mm x 52 mm x 34,1 mm KOYO ER205 deep groove ball bearings

Bearing No. ER205

Size	25x52x34.1 mm
Bore Diameter	25 mm
Outer Diameter	52 mm
Width	34,1 mm
d	25 mm
D	52 mm
B	34,1 mm
C	19 mm
S1	19,8 mm
a	2,38 mm
f	1,07 mm
r min.	1 mm
r1 min.	0,5 mm
C	5 mm
D2	57,7 mm
S	14,3 mm
S2	5,5 mm
Thread (G)	M6 x 0,75
Weight	0,27 Kg
Basic dynamic load rating (C)	14 kN
Basic static load rating (C0)	7,85 kN

ER205 Bearing 2D drawings and 3D CAD models